

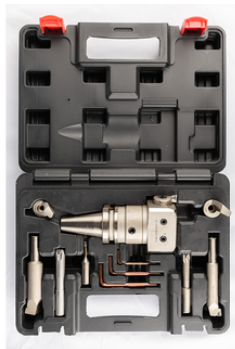

## NBH2084 (Dia 8-203) ACCkee Boring Head Set (Boring Kit)



[Click Here to Buy Online](#)  
[ACCkee Boring Kit NBH2084 \(Dia 8-203\)](#)

# High Accuracy Precision Boring Head ( 2084 )

## Technical Details for NBH2084 Boring Head

- ◎ 1 div = 0.01mm
- ◎ PAT. Diameter  $\phi 8 - \phi 203$
- ◎ Counter Boring Functions:  $\phi 112 - \phi 203\text{mm}$

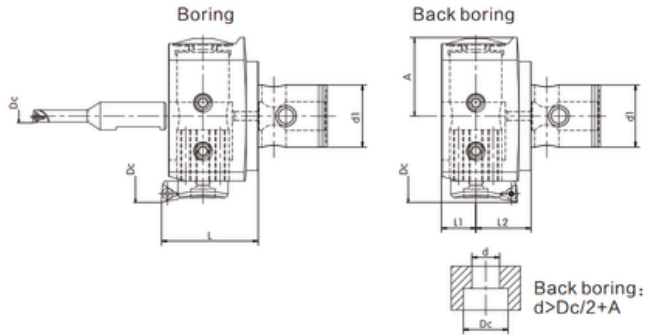

Specification	Boring				Depth	Insert	Clamp screw	wrench	kg		
	Dc	d1	L	Cutter Block							
CKB6-EWB08203-52	08-43	63	52	YBJ1608	32	TB..0601	M2.2*5	T7	0.11		
	12-47			YBJ1612	50				TP..0902	M2.5*6	0.12
	16-51			YBJ1616	65						0.18
	31-66			YBJ1631	90	TP..1103	M3*7		0.47		
	65-100			YBJ1665	90				0.65		
	100-135			ENH6-1	—				—		
	134-169			ENH6-2F	—				—		
	168-203			ENH6-3F	—	—					

Specification	Counter Boring				
	Dc	L1	L2	A	Cutter Block
CKB6-EWB08203-52	112-135	20	32	—	ENH6-1
	134-169	20	32	—	ENH6-2F
	168-203	20	32	—	ENH6-3F

# TWN Large Diameter Boring Head

○ Diameter:  $\Phi 151 - \Phi 750$

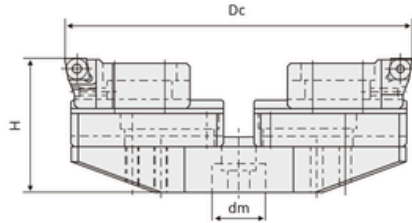

○ Two Kinds Of Material, Steel And Aluminum.

Specification	Dc	dm	L	Insert	Screw	Wrench	Slide fastening screws	boring cutter fastening screws	Slide side screws	boring cutter side screws	
RDH-D151-211-80L	151-211	32	80	CC..1204..	M5*13	T20	M8*25	M8*26	M6*20	M6*20	4.95
RDH-D210-290-80L	210-290	32	80	CC..1204..	M5*13	T20	M8*25	M8*26	M6*25	M6*25	5.85
RDH-D290-370-80L	290-370	32	80	CC..1204..	M5*13	T20	M8*25	M8*26	M6*25	M6*25	6.81
RDH-D370-450-80L	370-450	32	80	CC..1204..	M5*13	T20	M8*25	M8*26	M6*25	M6*25	7.80
RDH-D450-550-80L	450-550	32	80	CC..1204..	M5*13	T20	M8*25	M8*26	M6*25	M6*25	8.75
RDH-D550-650-80L	550-650	32	80	CC..1204..	M5*13	T20	M8*25	M8*26	M6*25	M6*25	9.85
RDH-D650-750-80L	650-750	32	80	CC..1204..	M5*13	T20	M8*25	M8*26	M6*25	M6*25	10.85

## Large Diameter Rough Boring Head by ACCKEE!

This remarkable tool is specifically tailored to deliver unparalleled precision and superior processing efficiency for all your boring needs. Armed with CCMT inserts, this innovative product ensures outstanding performance and results with every single use.



[Click Here to Buy Online](#)  
[Large Diameter Rough Boring Head](#)

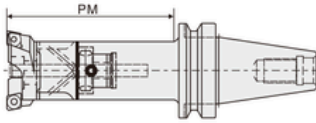

## ◎BT40 MAS 403 BT (ISO40)

Specification	Material	PM	Nose radius	Vc(m/min)	Speed (mm/φ)		Feed (mm/rev)	
					Recommend	MAX	Recommend	MAX
CKB1-TWN2026-35	P	73	0.4	110	1.7	2.0	0.16	0.20
	M			95	1.4	2.0	0.13	0.20
	K			60	1.4	2.0	0.14	0.20
	S			80	1.7	2.0	0.13	0.20
	S			130	2.0	2.5	0.20	0.25
CKB2-TWN2533-38	P	89	0.4	110	2.2	3.0	0.18	0.25
	M			95	1.8	3.0	0.16	0.25
	K			60	2.0	3.0	0.18	0.25
	S			80	2.2	3.0	0.16	0.25
	S			130	3.0	4.0	0.25	0.30
CKB3-TWN3242-43	P	105	0.8	150	3.2	4.0	0.22	0.30
	M			130	2.7	3.5	0.18	0.28
	K			70	2.7	3.5	0.22	0.30
	S			80	3.2	4.0	0.18	0.25
	S			130	3.5	5.0	0.25	0.30
CKB4-TWN4154-50	P	113	0.8	150	3.5	4.5	0.22	0.32
	M			130	3.5	4.5	0.20	0.30
	K			70	3.2	4.3	0.20	0.30
	S			80	3.5	5.5	0.20	0.30
	S			130	4.5	6.5	0.28	0.35
CKB5-TWN5372-60	P	122	0.8	150	5.3	6.5	0.25	0.35
	M			130	5.3	6.5	0.20	0.28
	K			70	4.5	5.5	0.20	0.28
	S			80	6.3	7.5	0.25	0.32
	S			130	7.5	9.0	0.30	0.38
CKB6-TWN6890-75 CKB6-TWN89120-75 CKB6-TWN115150-75	P	138	0.8	150	7.0	9.0	0.25	0.35
	M			130	6.3	9.0	0.22	0.30
	K			70	6.3	8.0	0.22	0.30
	S			80	7.2	9.0	0.25	0.32
	S			130	8.0	10.0	0.30	0.38

## ◎BT50 MAS 403 BT (ISO50)

Specification	Material	PM	Nose radius	Vc(m/min)	Speed (mm/φ)		Feed (mm/rev)	
					Recommend	MAX	Recommend	MAX
CKB1-TWN2026-35	P	81	0.4	110	1.7	2.0	0.16	0.20
	M			95	1.4	2.0	0.13	0.20
	K			60	1.4	2.0	0.14	0.20
	S			80	1.7	2.0	0.13	0.20
	S			130	2.0	2.5	0.20	0.25
CKB2-TWN2533-38	P	98	0.4	120	2.2	3.2	0.18	0.25
	M			110	1.8	3.2	0.16	0.25
	K			70	2.0	3.2	0.18	0.25
	S			85	2.2	3.2	0.16	0.25
	S			130	3.0	4.5	0.25	0.30
CKB3-TWN3242-43	P	125	0.8	170	3.2	4.5	0.22	0.30
	M			150	2.7	4.0	0.18	0.28
	K			85	2.7	3.5	0.22	0.30
	S			85	3.2	4.5	0.18	0.25
	S			130	3.5	5.0	0.25	0.30
CKB4-TWN4154-50	P	130	0.8	170	4.0	4.5	0.22	0.32
	M			150	3.5	4.5	0.20	0.30
	K			85	3.5	4.5	0.20	0.30
	S			85	3.5	5.5	0.20	0.30
	S			150	4.5	6.5	0.28	0.35
CKB5-TWN5372-60	P	140	0.8	180	6.3	7.2	0.25	0.38
	M			150	6.3	7.2	0.20	0.32
	K			100	5.3	6.3	0.20	0.32
	S			85	7.2	9.0	0.25	0.35
	S			170	8.0	11.0	0.30	0.40
CKB6-TWN6890-75 CKB6-TWN89120-75 CKB6-TWN115150-75	P	150	0.8	180	8.0	10.0	0.25	0.38
	M			150	7.0	10.0	0.25	0.32
	K			100	6.5	8.0	0.25	0.32
	S			85	8.0	10.0	0.25	0.35
	S			170	9.0	11.0	0.30	0.40

# TWN Twin-Cutter Boring Head



- Boring Range  $\phi 20 - \phi 150$
- Pay attention to the rigidity of rough processing
- The boring cutter and the boring head are tightened with three faces to enhance the rigidity
- boring cutter contour error  $\leq 0.02\text{mm}$

## Priority is given to rigidity.

- Triple contact for highest rigidity.



Cartridge and head are clamped together with face contact, increasing the rigidity for heavy duty boring.



- Capacity dia. 20-150mm!

### Wide diameter range

1 head accepts 2 different size cartridges.  
Example CKB1-TWN2026-35 provides capacity of dia.20 to 26 mm

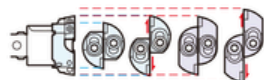

Covered by 8 different holes only

Massive thickness of cartridge eliminates vibration even under heavy cutting on  $\phi 0\text{mm}$  or boring with overlap set of cartridges. (Stepped cutting is not available.)

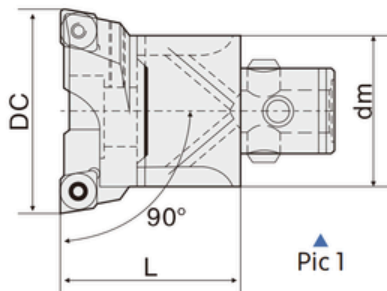

Blind hole

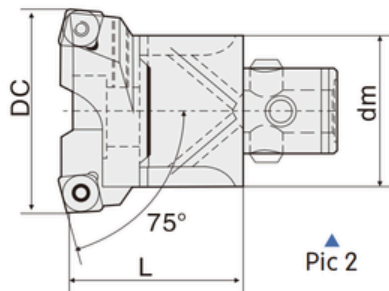

Through hole  
Made to order item

- (Rough boring head for blind hole-90°)

Specification	Dc	dm	L	Insert	Screw	Wrench	Cutter block	Screw	Cutter block screw	Side trimmer screw	kg	Pic
CKB1-TWN2026-35	20-26	19	35	CC..0602..	M2.5 x 6.5	T8	TW20-26M	M2.5*6	M4-0.7*16	M3*5	0.07	1
CKB2-TWN2533-38	25-33	24	38	CC..0602..	M2.5 x 6.5	T8	TW25-33M	M2.5*6	M5-0.8*18	M3*6	0.14	
CKB3-TWN3242-43	32-42	31	43	CC..09T3..	M4 x 10	T15	TW32-42M	M4*10	M6-1.0*20	M3*8	0.23	
CKB4-TWN4154-50	41-54	39	50	CC..09T3..	M4 x 10	T15	TW41-54M	M4*10	M8-1.25*25	M3*10	0.43	
CKB5-TWN5372-60	53-72	49	60	CC..1204..	M5 x 13	T20	TW53-72M	M5*12	M10-1.5*35	M4*12	0.82	
CKB6-TWN6890-75	68-90	63	75	CC..1204..	M5 x 13	T20	TW68-90M	M5*12	M10-1.5*35	M4*16	1.75	
CKB6-TWN89120-75	89-120	63	75	CC..1204..	M5 x 13	T20	TW89-120M	M5*12	M10-1.5*35	M4*16	2.25	
CKB6-TWN115150-75	115-150	63	75	CC..1204..	M5 x 13	T20	TW115-150M	M5*12	M10-1.5*35	M4*20	2.35	

[Click Here to Buy Online](#)  
[Rough Boring Head](#)

# EWN Large Diameter Boring Head



○ PAT. Diameter  $\phi 151 - \phi 750$

○ 1 div = 0.01mm



Aluminum

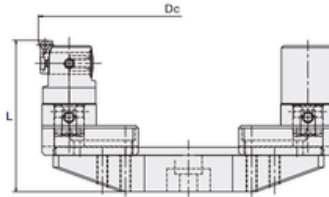

Steel

○ Two Kinds Of Material, Steel And Aluminum.

Specification	Dc	L	Insert	Screw	Wrench	Slide fastening screws	Wrench	Slider retaining adjustment screws	Wrench	
CDH-D151-211-84L	151-211	84	TP1103..	M3*7	M3*7	M8*25	L6	M6*20	L2.5	4.75
CDH-D210-290-84L	210-290	84	TP1103..	M3*7	M3*7	M8*25	L6	M6*25	L2.5	5.15
CDH-D290-370-84L	290-370	84	TP1103..	M3*7	M3*7	M8*25	L6	M6*25	L2.5	6.12
CDH-D370-450-84L	370-450	84	TP1103..	M3*7	M3*7	M8*25	L6	M6*25	L2.5	7.05
CDH-D450-550-84L	450-550	84	TP1103..	M3*7	M3*7	M8*25	L6	M6*25	L2.5	8.00
CDH-D550-650-84L	550-650	84	TP1103..	M3*7	M3*7	M8*25	L6	M6*25	L2.5	9.05
CDH-D650-750-84L	650-750	84	TP1103..	M3*7	M3*7	M8*25	L6	M6*25	L2.5	10.05

## Large Diameter Finish Boring Head (151-750mm by Acckee

your ideal solution for achieving high precision and outstanding performance during boring operations. The acckee finish boring head has been designed and manufactured in China using top-quality materials, ensuring its durability, reliability, and longevity.

[Click Here to Buy Online](#)  
[Large Diameter Finish Boring Head](#)



# EWN Precision Boring Head

**Reliable scale screw, 1 div=0.01mm on diameter and vernier scale.**

- Stable and higher precision achieved by pre-balanced design.
- Back boring is available as standard feature for greater versatility.

PAT. Diameter  $\phi 20 - \phi 203$

Coolant-Through hole

Vc max. 1200m/min

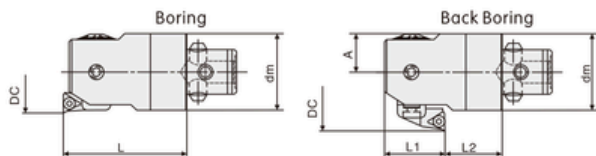

- 1 div = 0.01mm
- PAT. Diameter  $\phi 20 - \phi 203$

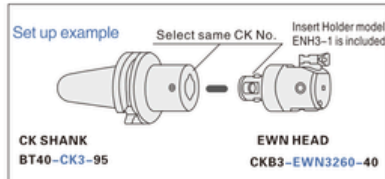

1 div=0.01mm /  $\phi$

Specification	Boring				Counter boring					Insert Size	Clamp screw	wrench	kg
	Dc	dm	L	Cutter block	Dc	L1	L2	A	Cutter block				
CKB1-EWN2036-32.5	20-26	19	32.5	ENH1-1	30-31	20	10	10	ENH1-2	TP..0802..	M2.2*5	T7	0.09
	25-31			ENH1-3					ENH1-3				
	30-36			ENH1-3					ENH1-3				
CKB2-EWN2547-35.5	25-33	24	35.5	ENH2-1	38-41	22	10	12.5	ENH2-2	TP..1103..	M3*7	T8	1.25
	32-40			ENH2-2					ENH2-2				
	39-47			ENH2-3					ENH2-3				
CKB3-EWN3260-40	32-42	31	40	ENH3-1	48-52	25	9	16	ENH3-2	TP..1102..	M2.5*6	T8	0.43
	41-51			ENH3-2					ENH3-2				
	50-60			ENH3-3					ENH3-3				
CKB4-EWN4174-47	41-54	39	47	ENH4-1	59-67	30	13	20	ENH4-2	TP..1102..	M2.5*6	T8	0.43
	53-66			ENH4-2					ENH4-2				
	61-74			ENH4-3					ENH4-3				
CKB5-EWN5395-57	53-70	49	57	ENH5-1	66-86	34	19	25.5	ENH5-1	TP..1103..	M3*7	T8	1.25
	68-85			ENH5-2					ENH5-2				
	78-95			ENH5-3					ENH5-3				
CKB6-EWN68150-71	68-100	63	71	ENH6-1	77-98	45	23	32.5	ENH6-1	TP..1102..	M2.5*6	T8	1.78
	93-125			ENH6-2					ENH6-2				
	125-150			ENH6-3					ENH6-3				
CKB6-EWN100203-71	100-153	63	71	ENH6-1	107-155	45	23	45.5	ENH6-1	TP..1103..	M3*7	T8	2.53
	125-178			ENH6-2					ENH6-2				
	150-203			ENH6-3					ENH6-3				

[Click Here to Buy Online](#)  
[Finish Boring Head](#)

# EWN Precision Boring Bar Cutting Conditions—BT40/BT50

## ◎MAS 403 BT40

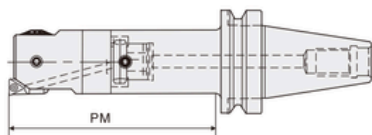

## ◎BT40 MAS 403 BT (ISO40)

Specification	Material	PM	Nose radius	(m/min)	(mm/φ)	Feed (mm/rev)	
						Recommend	MAX
CKB1-EWN2036-32.5	P	78	0.2	130	0.18	0.05	0.12
	M		0.2	100	0.18	0.05	0.12
	N		0.2	65	0.15	0.04	0.08
	K		0.2	80	0.25	0.05	0.10
	S		0.4	170	0.25	0.05	0.12
CKB2-EWN2547-35.5	P	93	0.2	150	0.25	0.05	0.12
	M		0.2	120	0.25	0.05	0.12
	N		0.2	80	0.15	0.04	0.08
	K		0.2	80	0.25	0.05	0.10
	S		0.4	180	0.25	0.08	0.12
CKB3-EWN3260-40	P	105	0.2	150	0.30	0.05	0.12
	M		0.2	120	0.30	0.05	0.12
	N		0.4	80	0.15	0.06	0.10
	K		0.4	80	0.35	0.08	0.12
	S		0.4	210	0.35	0.08	0.12
CKB4-EWN4174-47	P	105	0.4	150	0.30	0.06	0.12
	M		0.4	120	0.30	0.06	0.12
	N		0.4	80	0.15	0.06	0.08
	K		0.4	80	0.35	0.08	0.12
	S		0.4	210	0.35	0.08	0.12
CKB5-EWN5395-57 CKB6-EWN68150-71 CKB6-EWN100203-71	P	105	0.4	150	0.30	0.06	0.12
	M		0.4	120	0.30	0.06	0.12
	N		0.4	80	0.15	0.06	0.08
	K		0.4	80	0.35	0.08	0.12
	S		0.4	210	0.35	0.08	0.12

## ◎BT50 MAS 403 BT (ISO50)

Specification	Material	PM	Nose radius	(m/min)	(mm/φ)	Feed (mm/rev)	
						Recommend	MAX
CKB1-EWN2036-32.5	P	78	0.2	130	0.18	0.05	0.12
	M		0.2	100	0.18	0.05	0.12
	N		0.2	65	0.15	0.04	0.08
	K		0.2	80	0.25	0.05	0.10
	S		0.4	170	0.25	0.05	0.12
CKB2-EWN2547-35.5	P	105	0.2	150	0.25	0.05	0.12
	M		0.2	120	0.25	0.05	0.12
	N		0.2	80	0.15	0.04	0.08
	K		0.2	80	0.25	0.05	0.10
	S		0.4	180	0.25	0.08	0.12
CKB3-EWN3260-40	P	122	0.2	150	0.30	0.05	0.12
	M		0.2	120	0.30	0.05	0.12
	N		0.4	80	0.15	0.06	0.10
	K		0.4	80	0.35	0.08	0.12
	S		0.4	210	0.35	0.08	0.12
CKB4-EWN4174-47	P	122	0.4	150	0.30	0.06	0.12
	M		0.4	120	0.30	0.06	0.12
	N		0.4	80	0.15	0.06	0.08
	K		0.4	80	0.35	0.08	0.12
	S		0.4	210	0.35	0.08	0.12
CKB5-EWN5395-57 CKB6-EWN68150-71 CKB6-EWN100203-71	P	138	0.4	150	0.30	0.06	0.12
	M		0.4	120	0.30	0.06	0.12
	N		0.4	80	0.15	0.06	0.08
	K		0.4	80	0.35	0.08	0.12
	S		0.4	230	0.35	0.08	0.12